



2 Gloucester Drive, Sale, M33 5DH

£475,000

Viewing arrangements

Viewing strictly by appointment through the agent

95-97 School Road, Sale, Cheshire, M33 7XA 0161 962 2828

A well maintained DETACHED BUNGALOW in the sought after leafy suburbs of Sale, on a generous plot with manicured gardens. This lovely home offers generously proportioned and flexible accommodation throughout.
Briefly comprising: porch, entrance hallway, spacious bay fronted living room, fitted kitchen leading into conservatory with patio doors onto the garden, two double bedrooms and a bathroom with four piece suite. The property is fully double glazed and warmed by gas central heating (Worcester Bosch combi boiler). Externally, the property is set back from the road, with beautifully manicured front and rear gardens. The rear garden is mainly laid to lawn with mature stocked borders and patio area for seating. The detached garage and driveway are accessed via Taunton Road. CALL NOW TO VIEW!
NO CHAIN. COUNCIL TAX BAND D. EPC - Ordered

Porch

Access via uPVC double doors. Tiled flooring and light point.

Hallway

Spacious hallway, laminate flooring, radiator and light point.

Living Room

Good size bay fronted reception room with window to front aspect.

Carpeted flooring, ceiling light point and radiator.

Kitchen

Fitted kitchen with good range of wall and base units. Integrated oven, electric hob and extractor hood. Space and plumbing for washing machine and tall fridge freezer. Wall mounted combi boiler.

Conservatory

Conservatory with windows all round, enjoying views of the rear garden. Light point and radiator. Double doors onto the garden.

Garage

Beautifully manicured front and rear gardens stocked with a variety of plants and shrubs. The rear garden is mainly laid to lawn with mature shrubs, hedges and patio area for seating.

Externally

Four piece suite: low level WC, pedestal hand wash basin, corner shower cubicle and bath tub.

Bathroom

Double bedroom with window to side aspect. Carpeted flooring, ceiling light point and radiator.

Bedroom Two

Large double bedroom with windows to rear and side aspect. Carpeted flooring, ceiling light point and radiator.

Bedroom One

Viewing strictly by appointment through the agent

95-97 School Road, Sale, Cheshire, M33 7XA 0161 962 2828

Detached garage with gated driveway in front, access from Taunton Road. Fitted with light and electric sockets.



Energy Efficiency Rating		
	Current	Potential
<i>Very energy efficient - lower running costs</i>		
(92 plus) A		
(81-91) B		
(69-80) C		
(55-68) D		
(39-54) E		
(21-38) F		
(1-20) G		
<i>Not energy efficient - higher running costs</i>		
England & Wales	EU Directive 2002/91/EC	

Environmental Impact (CO ₂) Rating		
	Current	Potential
<i>Very environmentally friendly - lower CO₂ emissions</i>		
(92 plus) A		
(81-91) B		
(69-80) C		
(55-68) D		
(39-54) E		
(21-38) F		
(1-20) G		
<i>Not environmentally friendly - higher CO₂ emissions</i>		
England & Wales	EU Directive 2002/91/EC	



GROUND FLOOR
788 sq.ft. (73.2 sq.m.) approx.

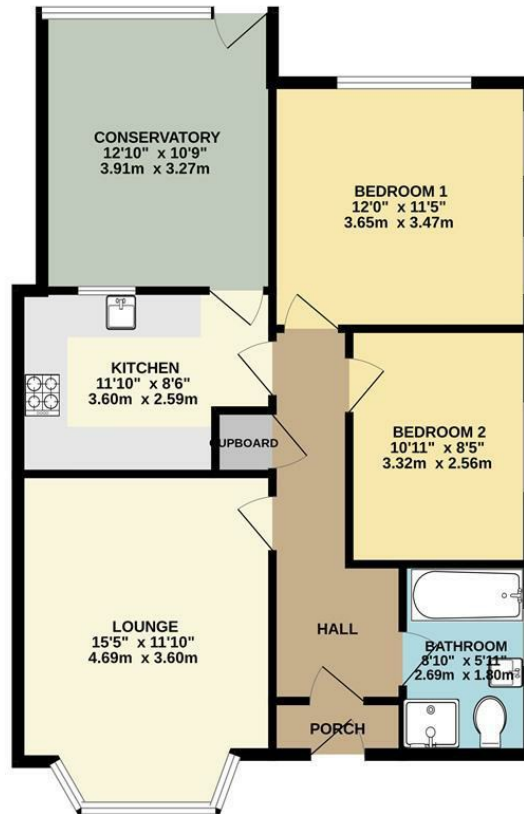

TOTAL FLOOR AREA : 788 sq.ft. (73.2 sq.m.) approx.
Measurements are approximate. Not to scale. Illustrative purposes only.
Made with Metropix ©2014



These particulars are believed to be accurate but they are not guaranteed and do not form a contract. Neither Jordan Fishwick nor the vendor or lessor accept any responsibility in respect of these particulars, which are not intended to be statements or representations of fact and any intending purchaser or lessee must satisfy himself by inspection or otherwise as to the correctness of each of the statements contained in these particulars. Any floorplans on this brochure are for illustrative purposes only and are not necessarily to scale.

Offices at: Chorlton, Didsbury, Disley, Hale, Glossop, Macclesfield, Manchester Deansgate, Manchester Whitworth Street, New Mills, Sale, Wilmslow and Withington

95-97 School Road, Sale, Cheshire, M33 7XA

0161 962 2828

sale@jordanfishwick.co.uk
www.jordanfishwick.co.uk

